

R2R-1100 PRO

ROLL TO ROLL DIGITAL PRINTER



NORITSU

R2R-1100 PRO

ROLL TO ROLL DIGITAL PRINTER

ROLL TO ROLL DIGITAL PRINTER

Those high volume digital printing jobs just got easier. The Noritsu R2R-1100 PRO offers high-speed print production, outputting of up to 1,216 10"x 8" prints in a single hour. With such features as 320 DPI print resolution, auto threading, auto splice detection and roll paper capacity up to 1,640 ft., this roll-to-roll digital printer represents a major advancement in both quality and speed. With variable print widths ranging from 4 to 12 inches, the R2R-1100 PRO offers the flexibility to process a wide variety of print jobs in the fastest time possible. Using a dedicated Ethernet connection to the main control computer, the R2R-1100 PRO delivers print processing simply and efficiently.

The Noritsu R2R-1100 PRO is the perfect partner for lab operators who require high volumes of digital print output and a simple yet robust interface to their existing processing and finishing facilities. Combining laser imaging with adjustable paper cassettes and Microsoft Windows, the R2R-1100 Pro offers simplified user operation and minimizes training requirements.

The R2R-1100 PRO is an important module in the Noritsu family of digital solutions. By offering the speed and quality for which Noritsu is well known, the R2R-1100 PRO can operate as the foundation of your high volume digital workflow. With performance that rivals or surpasses that of the fastest optical package printers, the R2R-1100 PRO is a powerful addition to the Noritsu portfolio of professional market equipment.



- Utilizes your existing network to efficiently print digital files on roll paper
- The laser exposure system enables high speed output of digital files from media to photographic paper 4 to 12 inches wide
- Dual punch marking system for cutting and sorting orders
- 1,640 ft. supply paper magazine
- 40 inch exposure advanced length supported

- Automatic transport with automatic paper threading feature
- Software interface: NetOrder
- Dual line backprinter
- Unsurpassed speed
- Increased flexibility



NORITSU

R2R-1100 PRO

R2R-1100	SPECIFICATIONS
EXPOSURE SYSTEM:	LASER SCANNING BY PAPER MOVEMENT
DISPLAY MONITOR:	17" COLOR DISPLAY MONITOR
PRINT RESOLUTION:	320 DPI
PAPER WITH:	4", 5", 6", 7", 8", 10", 11", 12"
PAPER ADVANCE LENGTH:	40" MAX/ 1.5" MIN
INTERFACE:	ETHERNET (100 BASE-T): 1 PORT, SUPPORTS TCP/IP PROTOCOL
SOFTWARE INTERFACE:	NETORDER 
IMAGE FORMAT (INPUT):	24 BIT RGB UNCOMPRESSED TIFF, JPEG, BMP
PAPER MAGAZINE:	SUPPLY MAGAZINE: 1,640 FEET MAX TAKE-UP MAGAZINE: 1,200 FEET MAX
OPERATIONAL WEIGHT:	1093 LBS.
DIMENSIONS:	52.8" (L) x 31.5" (W) x 70.2" (H)
POWER REQUIREMENTS:	1ø-2w, AC 200-240V, 50/60Hz, 5-6A
RATED POWER CAPACITY:	1.1~1.3 KVA

R2R-1100 APPROXIMATE PRODUCTION CAPACITY*		
PAPER WIDTH	ADVANCE	PRINTS PER HOUR
4"	6"	1,624
10"	8"	1,216
12"	18"	540

*CALCULATED ACCORDING TO OUR CRITERIA. ACTUAL CAPACITY YOU ACHIEVE MAY BE DIFFERENT DEPENDING ON VARIOUS CONDITIONS.

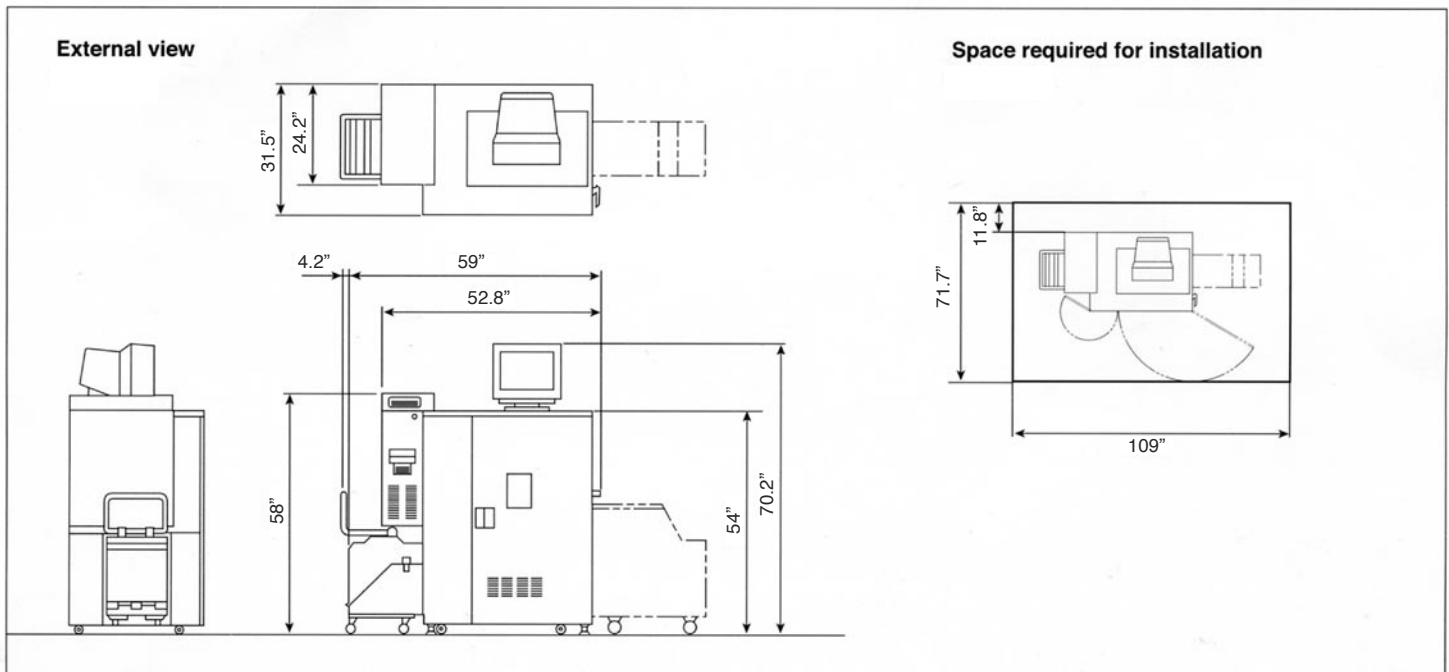

The specifications, information, and the appearance of the machine in this brochure, are subject to change without notice.

• **Noritsu America Corporation:** 6900 Noritsu Avenue, Buena Park, California 90620-1372 (714) 521-9040 • **Western Regional Office:** 6950 Noritsu Avenue, Buena Park, California 90620-1311 (714) 521-9040 • **Eastern Regional Office:** 336 Route 46 East, Fairfield, New Jersey 07004-2429 (973) 808-9898 • **Midwest Regional Office:** 755 Tollgate Road, Elgin, Illinois 60123-9334 (847) 888-8000 • **Southern Regional Office:** 2989 North Stemmons Freeway, Dallas, Texas 75247-6193 (214) 631-2400 • **Government Sales Office:** 8000 Towers Crescent Drive, Suite 1350, Tysons Corner, Virginia 22182-2700 (703) 821-0007 • **Subsidiary; Noritsu Canada Ltd.:** 2680 Argenta Road, Mississauga, Ontario, Canada, L5N 5V4 (905) 567-8982 • **Subsidiary; Noritsu de México S.A. de C.V.:** Plaza Mayorazgo de Luyando No. 7, Col. Xoco, Delegación Benito Juárez, C.P. 03330 México, D.F. 52-55-5601-4010

www.noritsu.com

NORITSU

CAT #R2R 6/03 5M