

A digital minilab with an array of growth-enhancing features suited for the photo retail needs of today and tomorrow.

QSS-37 SERIES

QSS-3701 / 3702 / 3703 / 3704 / 3705

		QSS-3701	QSS-3702	QSS-3703	QSS-3704	QSS-3705
Film types	LS-600 / 1100, HS-1800	Color negative and positive, B&W negative	←	←	←	←
Film formats	LS-600 / 1100	135F, 135H, 135P, 135FP, 135FPP, IX240	←	←	←	←
	HS-1800	110, 135F, 135H, 135P, 135FP, 135FPP, IX240, 6x4.5, 6x6, 6x7, 6x8, 6x9	←	←	←	←
Compatible input media*1	Standard	FD, HDD, CD-ROM, CD-R, CD-RW, DVD-ROM, DVD-R, DVD+R, DVD-RW, DVD+RW, DVD-RAM	←	←	←	←
	Option	Microdrive, CompactFlash, SmartMedia, SD Card, MMC, RS-MMC, Mini SD Card, Memory Stick, Memory Stick Pro, Memory Stick Duo, Memory Stick Pro Duo, xD-Picture Card, USB Flash Memory	←	←	←	←
Compatible output media*1	Standard	FD, HDD, CD-R, CD-RW, DVD-RAM	←	←	←	←
	Option	DVD-R, Microdrive, CompactFlash, SmartMedia, SD Card, MMC, RS-MMC, Mini SD Card, Memory Stick, Memory Stick Pro, Memory Stick Duo, Memory Stick Pro Duo, xD-Picture Card, USB Flash Memory	←	←	←	←
Print sizes	Paper width	82.5, 89, 102, 114, 117, 120, 127, 130, 152, 165, 178, 203, 210, 216, 240, 254, 279, 305 (mm)	←	←	←	←
	Paper advance length	Minimum: 82.5mm Maximum: 457.2mm when the width is 82.5 to 120mm / 914.4 when the width is 127 to 305mm	←	←	←	←
Exposure system		Laser exposure system	←	←	←	←
Print resolution		300dpi	←	←	←	←
Film scanning method (LS-600/1100, HS-1800)		Main scanning: Independent line exposure via 3 line CCD Sub scanning: Film movement	←	←	←	←
Paper supply		Dual magazine system (Standard) Triple magazine system (Factory option) / Quad magazine system (Factory option)	←	←	←	←
Order classification		14 / 17 orders	←	←	8 / 14 / 17 orders	14 / 17 orders
Dimensions		See "External View" below	←	←	←	←
Rated power capacity	AC200-240V 1P2W	5.0 (25A) ~5.5KVA (25A)	←	←	6.1 (31A) ~6.7KVA (31A)	←
	AC200-240V 3P3W	5.0 (16A) ~5.5KVA (16A)	←	←	6.1 (19A) ~6.7KVA (20A)	←
	AC346-415V 3P4W	5.0 (10A) ~5.5KVA (11A)	←	←	6.1 (13A) ~6.7KVA (14A)	←
Weight	Scanner (LS-600/LS-1100/HS-1800)	LS-600: Approx. 16.7kg / LS-1100: Approx. 17.5kg / HS-1800: Approx. 18.6kg	←	←	←	←
	Printer-Processor (Standard specification)	Approx. 539.4kg	Approx. 539.4kg	Approx. 546.4kg	Approx. 605.1kg	Approx. 570.7kg (Fuji chemicals)
Estimated processing capacity (prints/hr) [() represents capacity when using high-specification PC. Only high-spec PC is available for QSS-3704/3705.]						
135 negative film (24 exp.)	W127 x 89mm	LS-600	Approx. 600	Approx. 600	Approx. 600	Approx. 600
		LS-1100	Approx. 900	Approx. 1200	Approx. 1200	Approx. 1200
		HS-1800	Approx. 900	Approx. 1310	Approx. 1600 (Approx. 1650)	Approx. 2200
	W152 x 102mm	LS-600	Approx. 600	Approx. 600	Approx. 600	Approx. 600
		LS-1100	Approx. 900	Approx. 1180	Approx. 1200	Approx. 1200
		HS-1800	Approx. 900	Approx. 1180	Approx. 1480	Approx. 2000
	W203 x 254mm	LS-600	Approx. 190	Approx. 270	Approx. 350	Approx. 380
		LS-1100	Approx. 190	Approx. 270	Approx. 350	Approx. 510
		HS-1800	Approx. 190	Approx. 270	Approx. 350	Approx. 510
	W305 x 457mm	LS-600	Approx. 110	Approx. 130 (Approx. 160)	Approx. 130 (Approx. 200)	Approx. 220
		LS-1100	Approx. 110	Approx. 130 (Approx. 160)	Approx. 130 (Approx. 200)	Approx. 290
		HS-1800	Approx. 110	Approx. 150 (Approx. 160)	Approx. 150 (Approx. 200)	Approx. 240
Repeat printing	W127 x 89mm	Approx. 900	Approx. 1310	Approx. 1650	Approx. 2250	
	W152 x 102mm	Approx. 900	Approx. 1180	Approx. 1480	Approx. 2120	
	W203 x 254mm	Approx. 190	Approx. 270	Approx. 350	Approx. 510	
	W305 x 457mm	Approx. 110	Approx. 160	Approx. 200	Approx. 290	
Digital camera (4 megapixels)*2	W127 x 89mm	Approx. 900	Approx. 1310	Approx. 1650	Approx. 2250	
	W152 x 102mm	Approx. 900	Approx. 1180	Approx. 1480	Approx. 2120	
	W203 x 254mm	Approx. 190	Approx. 270	Approx. 350	Approx. 510	
	W305 x 457mm	Approx. 110	Approx. 160	Approx. 200	Approx. 290	
Digital camera (6 megapixels)*3	W127 x 89mm	Approx. 900	Approx. 1310	Approx. 1500 (Approx. 1650)	Approx. 2000	
	W152 x 102mm	Approx. 900	Approx. 1180	Approx. 1400 (Approx. 1480)	Approx. 2000	
	W203 x 254mm	Approx. 190	Approx. 270	Approx. 350	Approx. 510	
	W305 x 457mm	Approx. 110	Approx. 160	Approx. 200	Approx. 290	

*1 Capacities may vary depending on the PC, card reader used. Capacities shown above represent values when using the computer system supplied by Noritsu Koki. The actual capacity you achieve may be different.
 *2 Using 512MB xD Picture Card. 2304 x 1728 pixels per image.
 *3 Using 512MB xD Picture Card. 3024 x 2016 pixels per image.
 Calculated according to our criteria. The actual capacity you achieve may be different.

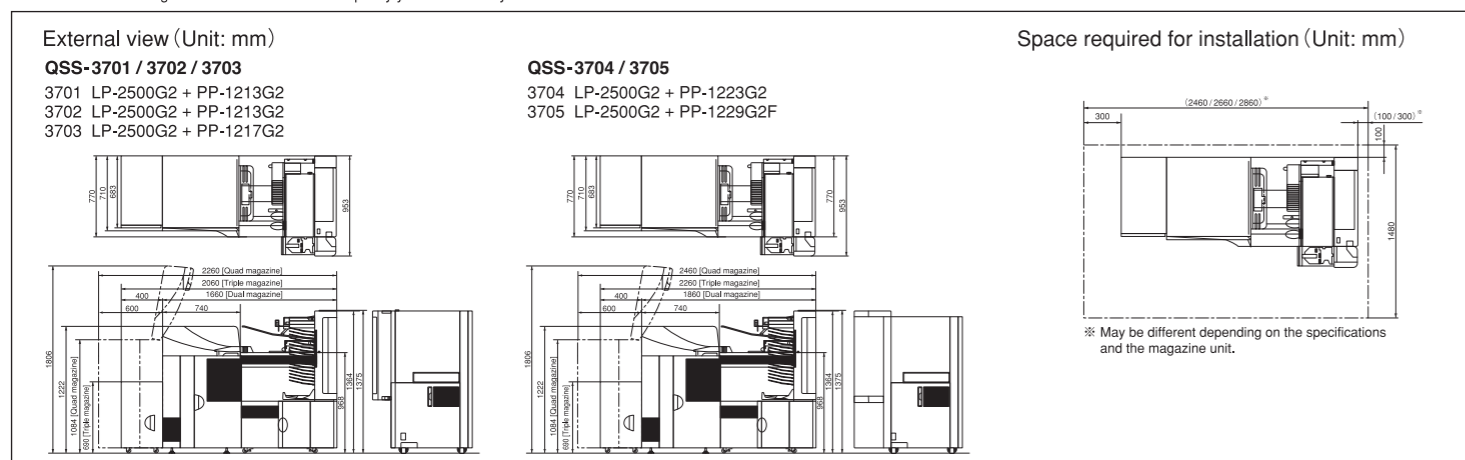

NORITSU KOKI CO., LTD.

579-1 UMEHARA, WAKAYAMA-SHI, 640-8550, JAPAN
 PHONE:(81)73-454-0345 FACSIMILE:(81)73-454-0301
 http://www.noritsu.co.jp

COUNTRY	OFFICE	PHONE NO.	COUNTRY	OFFICE	PHONE NO.
Australia	Noritsu Koki Australia Pty. Ltd.	(61) 2-9317-2141	Malaysia	Noritsu Koki Malaysia Sdn. Bhd.	(60) 3-78762733
Brazil	Noritsu Do Brasil Ltda.	(55) 11-3779-0607	Mexico	Noritsu Mexico S.A. De C.V.	(52) 55-2626-6710
Canada	Noritsu Canada Ltd.	(1) 905-567-8982	The Philippines	Noritsu Philippines, Inc.	(63) 2-812-8443
The Czech Rep.	Noritsu (CR) spol. sr. o.	(420) 241-040901	Poland	Noritsu (Poland) Sp. z o.o.	(48) 22-863-2800
China	Noritsu (Shanghai) E. E. M. Co., Ltd.	(86) 21-59169898	South Korea	Noritsu Seoul Branch	(82) 2-569-2701
China	Noritsu (Shanghai) P. E. M. Co., Ltd.	(86) 21-59169898	Russia	Noritsu (R) Ltd.	(7) 495-933-6446
France	Noritsu France E. U. R. L.	(33) 1-57-02-12-90	Singapore	Noritsu Singapore Pte. Ltd.	(65) 6778-8333
Greece	Noritsu Hellas Ltd.	(30) 210-6019506	Taiwan	Noritsu Taiwan Co., Ltd.	(886) 2-2508-1908
Germany	Noritsu (Deutschland) GmbH	(49) 2154-9157-0	U. A. E.	Noritsu Near East Branch	(971) 4-8837556
Hong Kong	Noritsu (Far East) Ltd.	(852) 2873-4788	U. K.	Noritsu (UK) Limited	(44) 1908-371100
India	Noritsu India Branch	(91) 11-41427245	U. S. A.	Noritsu America Corporation	(1) 714-521-9040
Italy	Noritsu Italia S. r. l.	(39) 0321-445211			

NORITSU, QSS and AccuSmart™ are trademarks of Noritsu Koki Co., Ltd.
 "Memory Stick" is a trademark of Sony Corporation.
 All other product and company names herein may be trademarks of their respective owners.

The specifications, information, and appearance of the machines herein are subject to change without notice.



Our products have been manufactured under an ISO 9001-certified quality assurance system.

Printed on recycled paper. 2007.08 TAC 01



The perfect product to build your shop around

QSS-37 SERIES

This powerful system will turn your retail outlet into a fun shop with diverse print services to choose from, and keep your customers coming back for more.



The QSS-37 series and a CT-SL input terminal. A perfect combination for digital photo shops!

Let the CT-SL handle your order taking

Customer choice is the wave of the future

Input terminals are already a very popular way for customers to place print orders, and they will gain even more importance in the future. Customers can use the CT-SL to choose which images they want to print, and use the attractive templates to make fun design prints. Furthermore, the CT-SL also enhances efficiency by eliminating order-taking hassle for the lab employees.



Big market potential for cameraphone prints

The CT-SL supports cameraphone prints. It provides a simple, convenient way for consumers to make prints from their cameraphone images, which is a trend that is expected to take off.

A variety of output possibilities with the high-quality QSS-37 SERIES

Attract customers with the wide variety of output possibilities this system provides!

Photofinishers need to do more than just provide 4x6 inch prints to be successful today. The ability to make a wide variety of alternate print sizes has become an essential feature. The QSS-37 series is a perfect retail solution, as it is capable of making everything from unique square shaped prints to Jumbo Panorama Prints (12x36 inches).

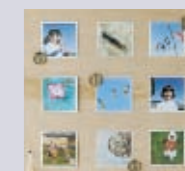

High quality output for your customers' important images

It's easy for customers who have made prints with their home printers to recognize that they are no match to the quality of silver halide prints. With high resolution, high quality digital cameras abundant in the market today, everyone is seeking the kind of superior print performance the QSS-37 series provides.

Attract customers and improve revenue with a wide variety of print services



Jumbo Panorama Prints (12 x 36 inches)



Square Photos



Design Albums

Many other kinds of print services including

- Panorama photos
- ID photos
- Photo business cards
- Greeting cards
- Enlargements (12 x 18 inches, etc.)
- Print to print
- Index prints
- Contact print style photos
- CD/DVD writing
- Prints from positive film



Retail print services

High quality! Exciting!

Providing high quality prints and exciting value-added services is the key to future success. The QSS-37 series provides the quality and the exciting solutions needed to fulfill a diverse range of customer needs.



Going all out to bring customer satisfaction



"Quality, Speed, Multi-Function" Three qualities retailers need to satisfy today's customers.

Digital cameras continue to become more prevalent, and the quality of cameraphones has improved. This has resulted in more high resolution images in consumers hands, making speed and quality even more sought after in photo shops than before. The QSS-37 series was designed to provide the quality and speed you need to be successful today, and its flexibility also enables you to adapt to the ever-changing print demands.

Quality

Quality that exceeds anything that can be made at home.

The image quality of digital cameras keeps getting better and better, and now the strong market presence of digital SLR cameras raises the quality bar even further. The QSS-37 series is the perfect choice for outputting these high resolution images, as it has Noritsu's image optimization technology and many other features to fulfill the demand for top quality prints.

Speed

A minimum amount of time is required for each order, whether large or small.

The QSS-37 series features rapid processing, so as to provide a speedy print service for orders of all sizes.

Multi-Function

Get customers in the door with a 4R print service. Take them to the next level with a diverse range of services.

The QSS-37 series supports a wide variety of value-added prints in sizes up to 305 x 914mm (12 x 36 inches).

Quality

The essence of the photo shop

Noritsu's image processing technology "AccuSmart" is applied to ensure the same high level of quality in each image produced



Noritsu Koki's AccuSmart image processing technology faithfully portrays natural-looking scenes with appropriate correction, and also enables you to perform special correction / manipulation when desired. AccuSmart's diverse correction features enable you to turn all kinds of shots into beautiful pictures.

Automatic correction of dust / scratches on film

- ▶ Digital Ice™
- ▶ Digital Masking Option

DIGITAL ICE™ automatically discovers and corrects dust and scratches on the base layer of film, and Digital Masking automatically corrects dust and scratches on the emulsion layer to make blemish-free prints.

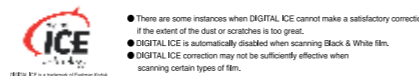

Automatic correction resulting in natural-looking scenes, and an array of special-effect correction functions for specific scenes

- ▶ Image optimization
- ▶ Special correction software Option

Cross filter software
Soft filter software
Red eye correction
Tone curve correction, etc.

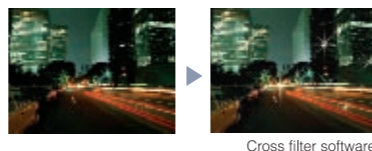

High quality laser engine

The ability to provide professional silver halide quality when delivering prints will be an important sales point for retailers aiming to stay ahead of the competition. Noritsu Koki's digital laser engine produces high quality prints that satisfy even the most demanding customers.

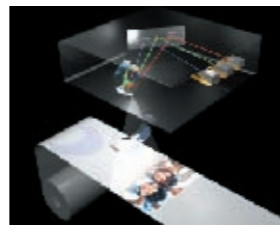

Speed

One-stop print service

Even large volumes can be printed on the spot

As the resolution of digital cameras increases, we are seeing larger image sizes as well as higher-capacity memory cards. This has led to the frequent processing of high resolution images and large-volume orders, making the print processing speed a determining factor for photofinishers. The superior processing speed of the QSS-37 series enables rapid processing of large volumes of high resolution images, and thereby ensures that print orders of all sizes are provided smoothly.

QSS-3701 Approx. 900 prints / hr	QSS-3702 Approx. 1,180 prints / hr	QSS-3703 Approx. 1,480 prints / hr
---	---	---

QSS-3704 Approx. 2,120 prints / hr	QSS-3705 Approx. 2,360 prints / hr
---	---

※Repeat printing, W152x102mm. Calculated according to our criteria. The actual capacity you achieve may be different.

Rapid processing for a one stop print service (Using specified chemicals)

The QSS-37 series supports rapid processing using a combination of Fujifilm CP-49E chemicals and Fujifilm Color paper to provide a high quality one-stop print service where the customers can place their order and pick up their prints in the same visit.



EZ Controller (Sold separately)

The EZ Controller takes care of everything from print order management to color correction of the individual images. The EZ Controller can be installed in networked computers, providing a flexible system in which image editing can be carried out with multiple computers.



EZ Order Display



PJP Display

Multi-Function

A wide variety of prints

Customers can use the CT-SL to make whatever kind of prints they want

Customer-operated terminals can be found in just about every photo shop these days. With its user-friendly GUI and its attractive templates, the CT-SL serves as the customer's gateway to the vast potential of the QSS-37 series.

▶CT-SL (sold separately)

A compact consumer-operated terminal that accepts an extensive variety of media. The user-friendly touch screen makes placing print orders an enjoyable experience for the customers.



Use Noritsu's wide variety of value-added print services to show your customers how fun making prints can be

An important topic for retailers as they seek revenue sources in the days ahead will be getting customers to do something special with their images, in other words make and display unique hard copies of these images. The QSS-37 series is a perfect solution for answering these demands.

▶A wide variety of print services from Jumbo Panoramas to Square Photos



Jumbo Panoramas (12 x 36 inches), Square Photos, Design Albums, etc.

▶CD / DVD writing Option



Can provide media writing services

▶Tiling Option

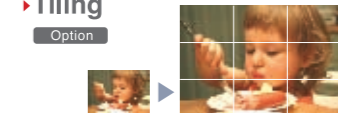

Tiling enables you to divide an image into multiple sections and print them on separate pieces of paper, which can be placed together to make a large print.

▶Prints from prints (Flatbed scanner is furnished by the customer)



If your customer has a photo that is special to her, you can scan it with a flatbed scanner even if she does not have her negative. Once the photo is turned into digital data, it can be corrected and faded colors can be restored, and then it can be printed over and over again.



A high level of efficiency ensuring smooth services



Triple magazines / Quad magazines (Factory Option)

You can choose to have a dual magazine system (Standard), a triple magazine system (Option), or even a quadruple magazine system (Option)! The ability to set up to four paper magazines provides a huge advantage in paper-replacement efficiency.



Triple magazine system



Quad magazine system

Interrupted orders signified by LED lamp

It is possible to interrupt an order to give preference to a rush order, in which case the orders can be distinguished by LED lamps on the order sorter.

A choice of order sorters

There are 2 types of order sorters to choose from for the QSS-3704. You can choose a 6-inch sorter or a 10-inch sorter.



Interrupting orders are indicated by an orange lamp.



Wide (10 inch) order sorter

※The 10-inch order sorter does not support the LED lamp function.

Bravo II / Rimage (Sold separately)

Automatic CD-R writing is possible with external CD-R writers, which enable thumbnail images to be printed on the face of the CD. These writers can be connected directly to the EZ Controller, helping to keep the system costs at a minimum.



Bravo II



Rimage (Producer III 7100N)



Thumbnail image printing

Automatic functions

Auto daily setup

Daily setup is carried out automatically using the program timer. This reduces the prep time required before business hours, helping you to reduce labor fees and use your time more efficiently.

Automatic calibration with the colorimeter

The colorimeter is built into the processor. During setup, the setup print is automatically inserted into the colorimeter as it comes out of the dryer.



Colorimeter

Control Strip Auto Loading Unit (Option)

You can set the control strip in the Auto Loading Holder Unit without a leader and set this unit in the processor. Doing so enables the control strip to be processed automatically when processing begins.



Control Strip Auto Loading Unit

Film scanner can be added according to your needs (Sold separately)

Whatever your input needs may be, the QSS-37 series has you covered. Labs that specialize in prints from digital media do not need to purchase a film scanner.



Scanning capacity (135F) ※1

LS-600※2
Approx. **600** frames/hr
(1002×1512 pix)

LS-1100※2
Approx. **1,200** frames/hr
(1002×1512 pix)

HS-1800
Approx. **1,600** frames/hr
(2,200)※3
(1037×1565 pix)

※1 The print capacity varies according to the printer-processor used.
※2 135 / IX240 only. No carrier required.
※3 Using high-spec PC.



The QSS-37 series supports a variety of networks



Efficient network system

EZ LAB enables efficient processing with multiple printers

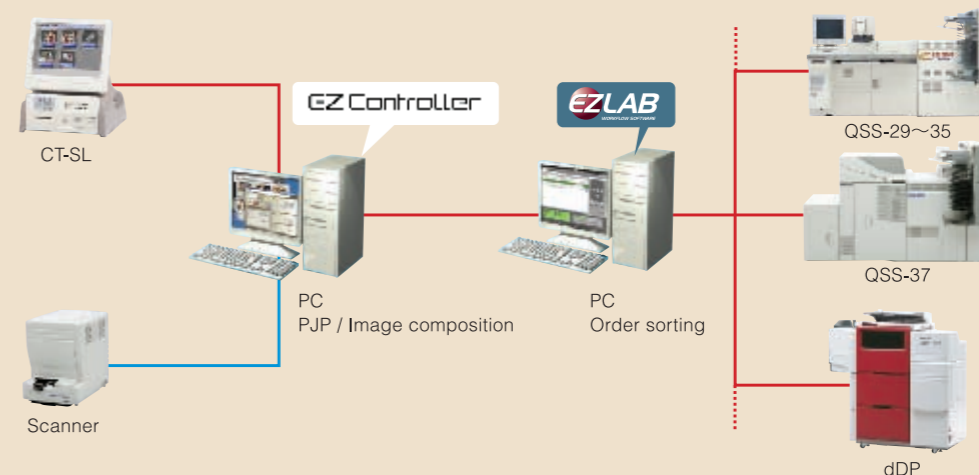

You can easily control multiple printers by installing a PC for PJP / Image composition and using EZLAB software. Installing EZLAB software in the order sorting PC enables you to divide the print orders among up to 8 printers, and thus provide an efficient print service.

Effectively divide the workflow by adding EZ Controller terminals

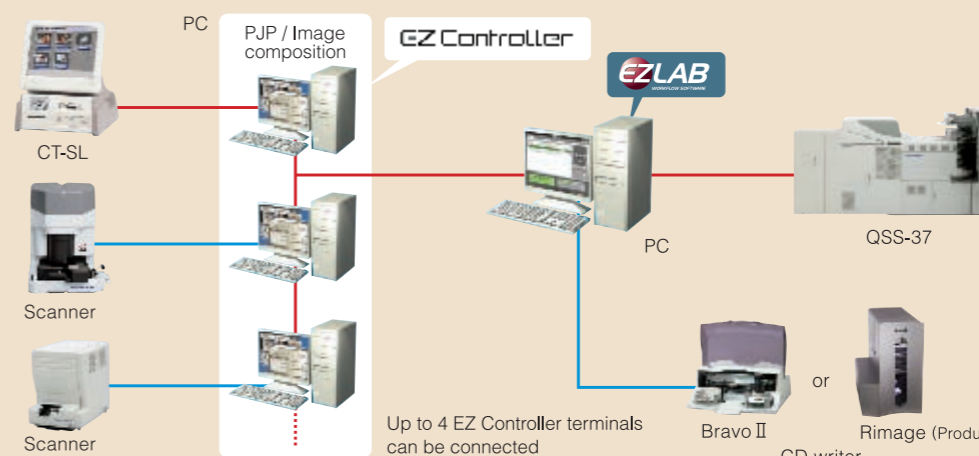

PJP, image correction and other tasks can be divided up and carried out on separate PCs, making for an efficient system that allows printing and editing to be performed simultaneously. This is an ideal solution for high-volume minilab shops and outlets promoting one-stop prints.

Display module (Option)

You can display error messages on the display module even if it is separated from the EZ Controller. This enables you to quickly recognize and solve any problems that may arise.



EZLAB (Option)

EZLAB provides an excellent solution when using a network with multiple printers and/or multiple computers, as it manages all the order data in the network.

Noritsu Quick Access (Option)

If you use the optional Noritsu Quick Access, you can output image data to the printer directly without using the EZ Controller or EZLAB. Even novices will find its drag & drop operations easy.



(You must adjust the image size to fit the print size)